



**8 Hunters Rise, Kirby Bellars, Melton Mowbray,
LE14 2DT**

£475,000

Shouler & Son
Land & Estate Agents, Valuers & Auctioneers

**8 Hunters Rise
Kirby Bellars
Melton Mowbray
LE14 2DT**

Nestled in the charming village of Kirby Bellars, Melton Mowbray, this delightful, detached bungalow offers a perfect blend of comfort and convenience. The property exudes a sense of character while providing modern living spaces that cater to today's lifestyle.





Description

This exceptional detached bungalow, located in the peaceful village of Kirby Bellars, is presented in turn-key condition, offering a perfect balance of modern living and comfort. Upon entering, you are greeted by a spacious reception hallway, featuring elegant windows that allow natural light to flood the space, creating a welcoming and bright atmosphere. The hallway leads into an open plan sitting room and dining area, providing a fluid, inviting space that is ideal for both relaxation and entertaining. The dining area conveniently connects to a well-equipped fitted kitchen, offering easy access for meal preparation and everyday living.

The bungalow comprises three well-proportioned bedrooms, with the principal bedroom offering a private retreat, complete with en-suite facilities and charming French doors that open directly to the garden, allowing for easy access to the outdoors. The remaining two bedrooms are serviced by a separate family bathroom, thoughtfully designed to cater to the needs of the household.

Outside, the property features ample off-road parking, ensuring convenience for residents and visitors alike. To the rear, a beautifully maintained garden awaits, offering a peaceful sanctuary. The garden includes a decked seating area, ideal for enjoying warm summer evenings, as well as a lush lawn bordered by a variety of plants, trees, and shrubs, providing both privacy and a natural backdrop.

A standout feature of this home is the superb timber-built summer house, which offers a bar, seating area, and electrics for home entertainment, making it the perfect space for hosting gatherings or enjoying leisure time. Behind the summer house, there is a purpose-built space currently used as a home gym, this private and dedicated space is ideal to make it your own. This property offers a wonderful opportunity to enjoy modern living in a picturesque setting, with all the amenities needed for a relaxed, comfortable lifestyle.

Hunters Rise is perfectly positioned to enjoy the picturesque surroundings of Melton Mowbray, known for its rich history and vibrant community. This bungalow is not just a house; it is a place where memories can be made and cherished for years to come. Whether you are looking to downsize, seeking a family home, or simply wishing to enjoy the benefits of single storey living, this property is sure to impress.



Sitting Room



Dining Area



Kitchen



Kitchen



Bedroom 2



Bedroom 3



Bedroom 1



En-suite

8 Hunters Rise, Kirby Bellars
Approximate Gross Internal Area = 112 sq.m/1201 sq.ft

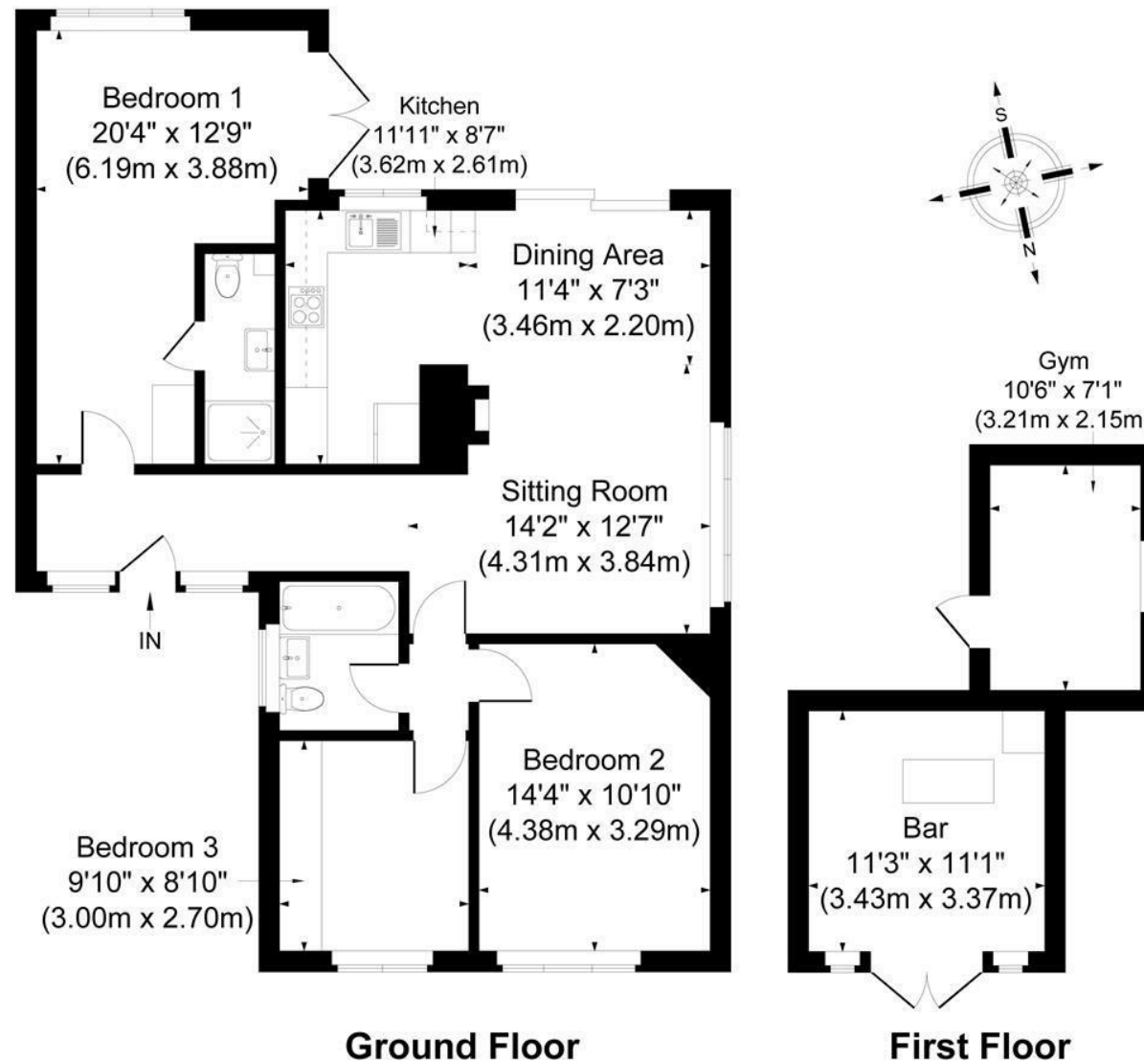
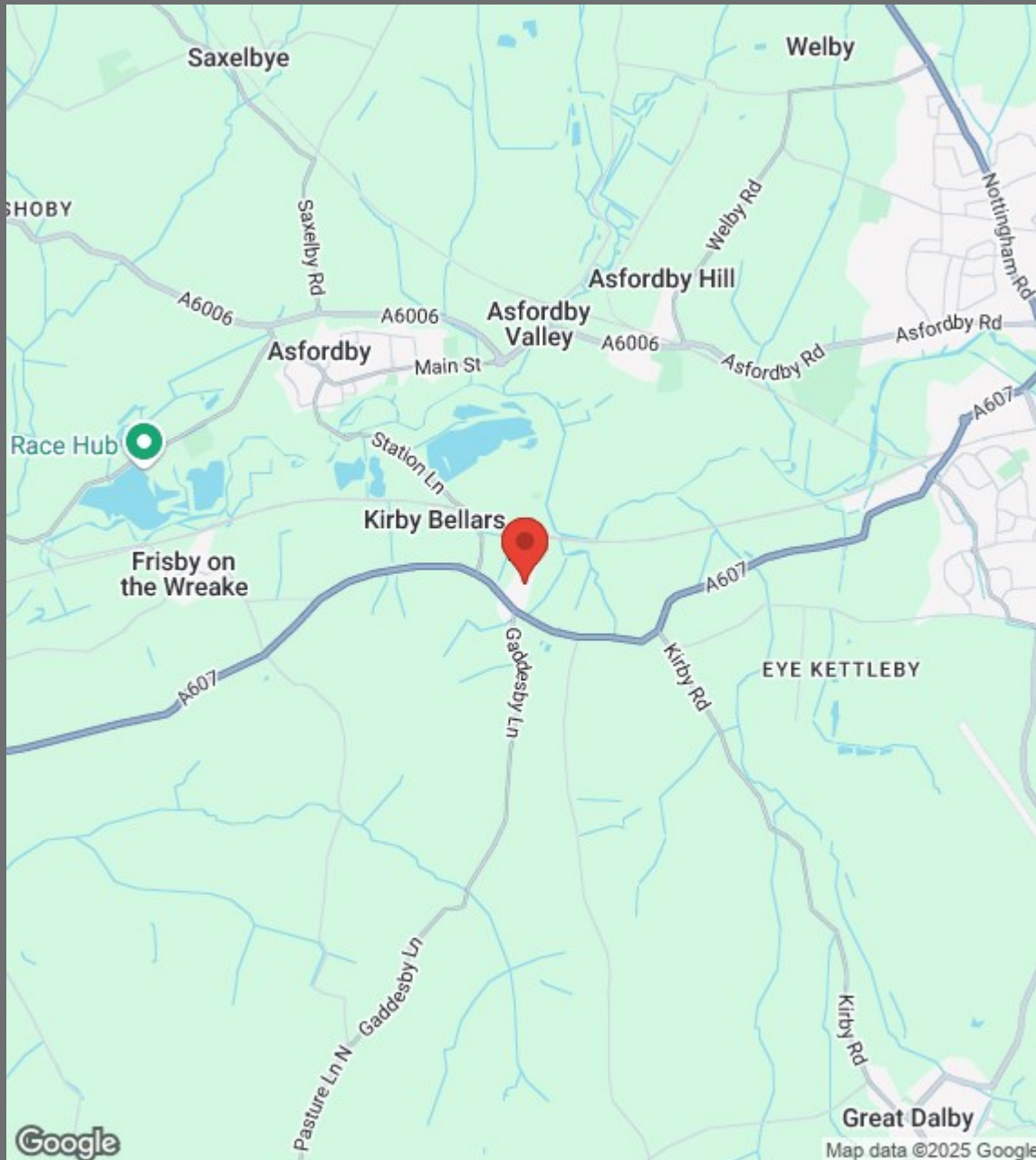

Illustration for identification purposes only, measurements are approximate, not to scale.
JonHolmesPhotography © 2025



- Exceptional detached bungalow
- Turn-key condition
- Spacious open-plan living
- Three well-proportioned bedrooms
- Principal bedroom with en-suite and garden access
- Beautifully maintained rear garden
- Decked seating area
- Superb timber-built summer house with bar
- Separate versatile gym/hobby room
- Ample off-road parking



sleepess.splash.lied

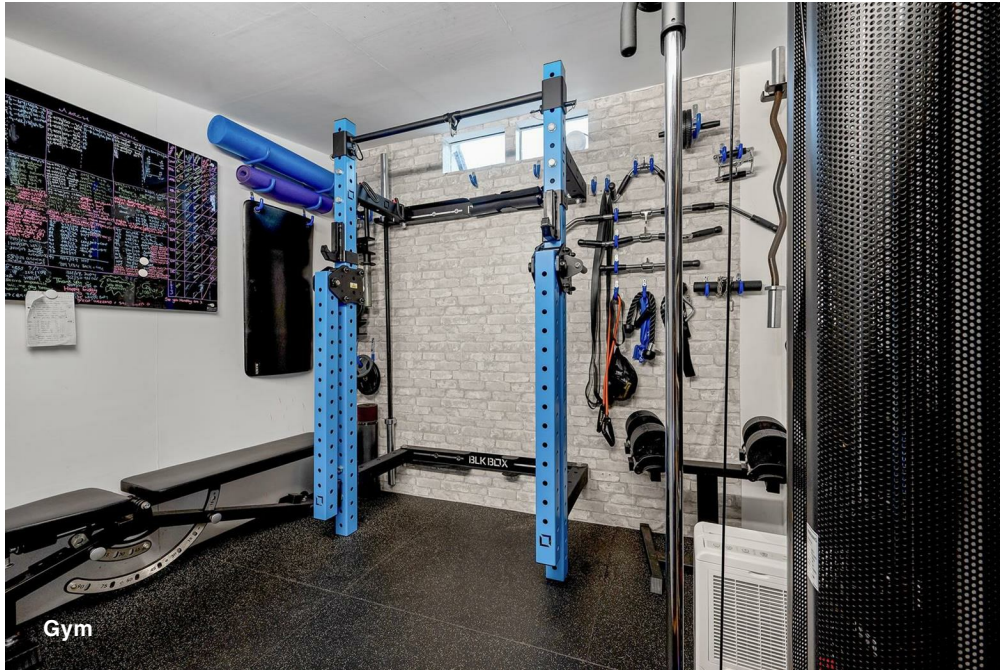

Gym



Bar



Rear Garden



Seating Area



County Chambers, Kings Road,
Melton Mowbray, Leicestershire LE13 1QF

www.shoulers.co.uk
salesenquiries@shoulers.co.uk

Tel: 01664 560181

 **Shouler & Son**
Land & Estate Agents, Valuers & Auctioneers

We produce property particulars in good faith and believe them to be correct. We generally rely on what we are told without obtaining proof. You should verify for yourself such information before entering into a contract to take this property. Neither Shouler & Son nor their clients guarantee accuracy of the particulars, and they are not intended to form any part of a contract. No person in the employment of Shouler & Son has authority to give any representation or warranty in respect of this property.